

10056116-2001042-ML020

NO.	REVISION	DATE	APPROVED

OWNER	PROJECT NAME	ORDER No.	Rev No.	MARKS	QTY	ITEM No.	ITEM NAME	APPLICATION	WEIGHT
ISKENDERLIH/TURKEY	ISD-HSM	1005611622	000021	280	32	2210312	F1-F4 MILL PROPER	STEP LINE	0.47kg
				300	18	2210313	F5-F6 MILL PROPER		

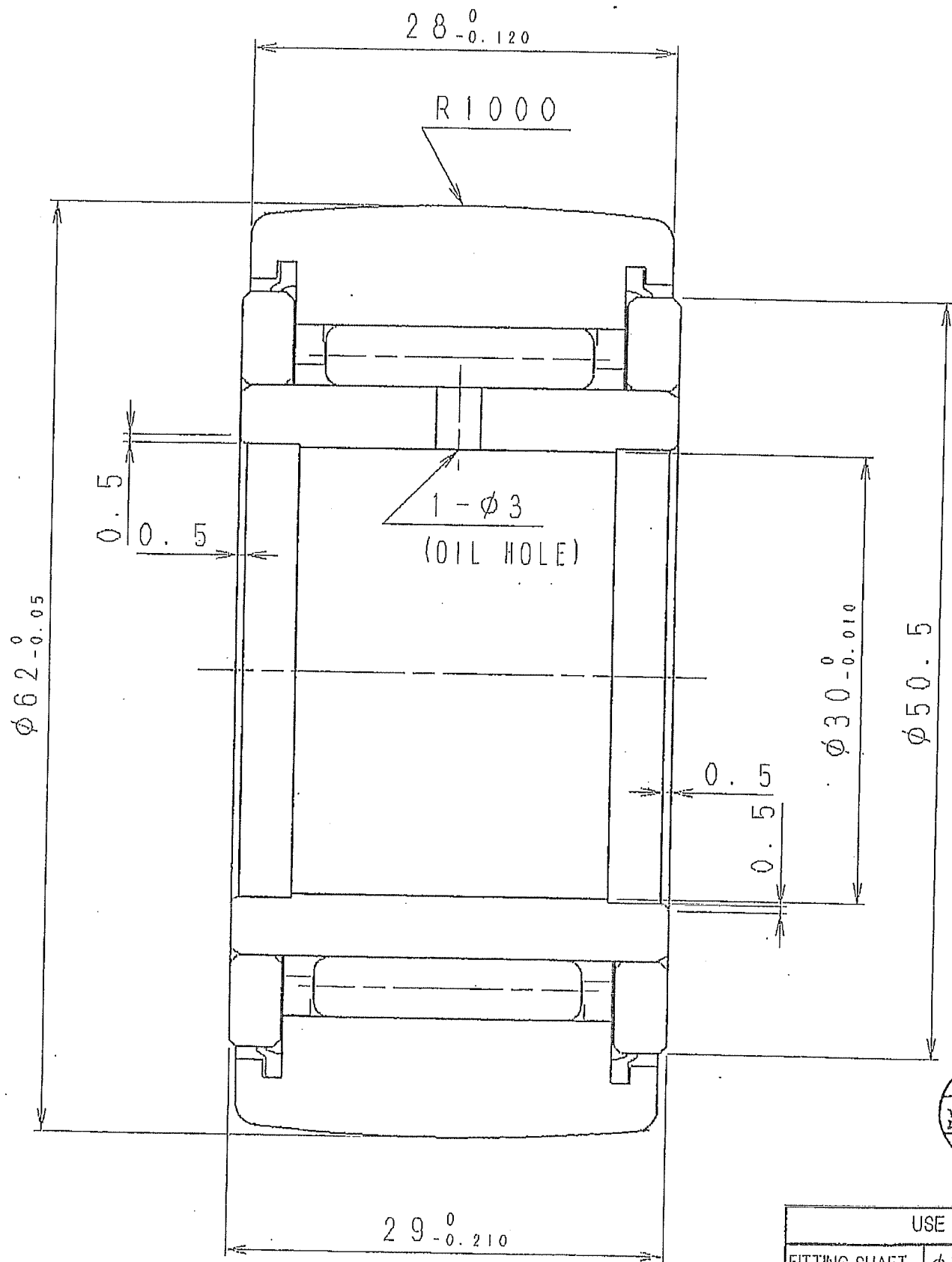

NOTES)

- BASIC LOAD RATINGS  
 $C = 33.4 \text{ kN}$   
 $C_0 = 51.4 \text{ kN}$
- RADIAL INTERNAL CLEARANCE  
 $: 0.010 \sim 0.040$
- LITHIUM SOAP BASED GREASE No. 2 SEALED IN.

**FINAL**

NO.	PART NAME	MATERIAL	QTY.	REMARKS
6	SEAL	—	2	—
5	ROLLER	SUJ2	~	JIS B 1506
4	CAGE	—	1	—
3	SIDE PLATE	SUJ2	2	HRC50~60
2	OUTER RING	SUJ2	1	HRC58~64
1	INNER RING	SUJ2	1	HRC58~64

Messrs. MITSUBISHI-HITACHI METALS MACHINERY, INC

SUBJECT  
NART.30UUR

DRAWING NO.  
D0001412T020

DRAWN	CHECKED	APPROVED	DATE	SCALE
KIMURA	SUDOU	KOISO	Nov. 29'05	

USE CONDITIONS	
FITTING SHAFT	$\phi 30_{-0.05}^{-0.10}$
LUBRICANT	ALVANIA EP-1 or EQUIVALENT
LUBRICATION	GREASE LUBRICATION



**THK** LM SYSTEM **THK CO., LTD.** TOKYO JAPAN

1.4-11-1-13

© THK CO., LTD.